

# GHIL

## CONCEALED DOUBLE FRAME SYSTEM WITH STRUCTURAL ADHESIVE 6MM THICK TILES

### HORIZONTAL SECTION

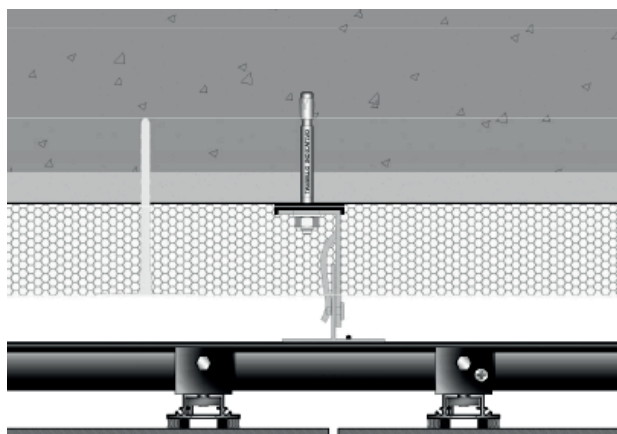

### VERTICAL SECTION

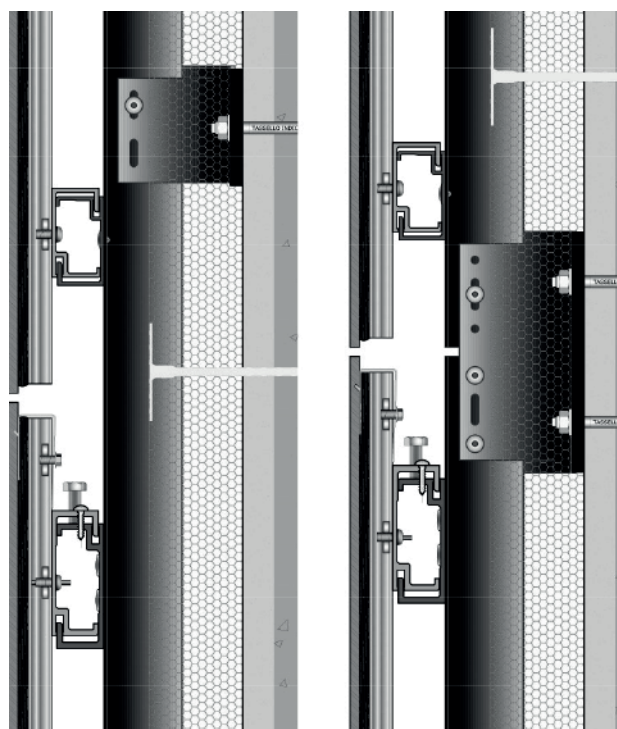

**GHIL ventilated facades consist of the following components:**

- L-section **anchor bracket** with **anchor bolts**, **safety accessory** and **thermal spacer** to be positioned between the anchor bracket and the building wall.
- Black painted T-section **uprights**, where necessary they may be substituted for tubular square profiles
- Painted C-section **cross pieces**.
- **Silver anodized secondary support profile**.
- **Concealed accessory for fixing** the tile to the primary frame.
- **6mm porcelain tile** installed with continuous vertical joints or staggered vertical joints.